

# 7 Series Laboratory Cabinets

DESIGNED FOR THE MODERN LAB.  
HUNDREDS OF CONFIGURATIONS.  
DURABLE FOR EVERYDAY USE.  
ATTRACTIVE CLEAN DESIGN.  
DOUBLE WALL CONSTRUCTION.  
SIMPLE TO PLAN, INSTALL, USE.



**CARR**

# 7 Series

## About Carr

### Table of Contents

CARR WAS ESTABLISHED IN 1946 to build the finest quality medical equipment. Based in Santa Monica California, it has prominent installations on all continents, including Antarctica. Its innovative imaging systems were even selected for the SR-71 and Apollo moon landing programs. Our design philosophy: "The greatest sophistication is simplicity" - Da Vinci.



DATA SHEET TABLE OF CONTENTS

Features.....	3
Specifications.....	4
Installation.....	6
Base Cabinets, Standing Height.....	7
Base Cabinets, Full Height.....	10
Wall Cabinets, 12" Deep.....	13
Wall Cabinets, 16" Deep.....	14
Wall Corner Cabinets 12", 16" Deep..	15
Finishing Accessories.....	16

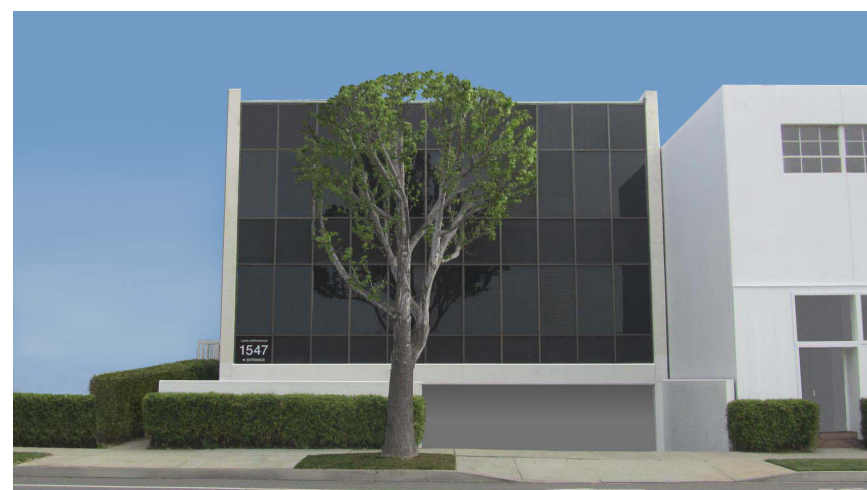

# 7 Series Features

70 YEARS EXPERIENCE built into each and every cabinet manufactured.

MODERN APPEARANCE. The 7 Series compliments work space design with a clean, sophisticated look.

STAINLESS STEEL CONSTRUCTION is superior to other materials because it is inert, nontoxic, chemical resistant, non-absorbent, has an integral finish that does not chip or flake and is inherently durable. It is made of 85% recycled material, 100% recyclable.

DURABLE for institutional use. Double wall construction. Fully welded and reinforced body. Heavy duty hardware and drawer slides. Tempered glass. Hinges are full door height, not just two 3" high individual hinges.

COMPLETELY ENCLOSED BODY that includes tops and backs insures proper isolation of stored contents.

SMOOTH INTERIORS have flush shelf ladders and unobstructed surfaces making sterilization more effective.

CARR CORPORATION  
carrcorp@aol.com - 800 952 2398  
carrcorporation.com - 9/14 - Page 3

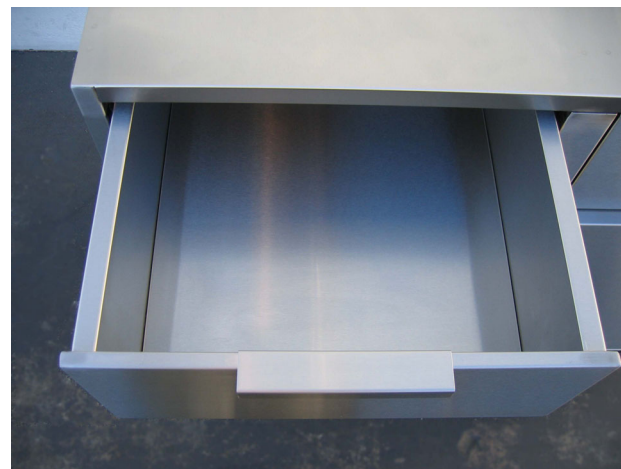

# 7 Series Specifications

**DESIGN:** 7 Series Casework is designed for the unique requirements of medical and laboratory environments. It is intended to be highly durable for daily use yet feature a modern appearance. Cabinets meet all applicable industry standards such as MILSPEC.

**CONSTRUCTION:** Double wall construction throughout. Body structure consists of two outer panels formed into a pan with front bends creating the vertical channels. Onto this is welded a back panel with strengthening bends. Horizontal beams are welded cross the front between the outer body panels contributing to lateral stability. Onto this assembly is placed the outer top and bottom with horizontal channels which cover the horizontal beam. Into the interior sides is welded another pan panel with built-in shelf ladder perforations. Into the inner top and bottom are welded a pan section panel that create a flush interior with no dead spaces. Cabinet face is flush with no overlapping metal. The fully enclosed cabinet body is then sealed and caulked for complete moisture proofing.



# 7 Series Specifications

**STAINLESS STEEL** Type 304 # 4 finish.  
Body, doors 14 gauge (2 layers of .020).  
Back panel, hrz beams 18 gauge.  
Shelves, drawers, 20 gauge construction.

**DOORS** Double pan, 5/8" thick, sound insulated, doubler panel hinge support.

**DRAWERS** Welded with smooth interior.  
Two 100 Lbs capacity ball bearing slides.

**SHELVES** Pan construction, adjustable in .500" increments. Flush ladders in sides.

**HANDLES** 7" Wide stainless with nylon inserts, 4" centers, hidden interior screws.

**HINGES** Full height piano hinges, .170" thick SS, .100 dia. pin. Self lubricating.

**DOOR CATCHES** Two .25" dia. rollers, chrome plated spring steel receptacles.

**BASE** Removable, 3" deep toe space.

**GLASS** Tempered safety glass, .250" thick, clear seamed, removable, gasket.

**LOCKS** Optional. Replaceable cores, keyed same or different upon request.

**CARR CORPORATION**  
carrcorp@aol.com - 800 952 2398  
carrcorporation.com - 9/14 - Page 5

A technical line drawing showing the front view of a stainless steel cabinet. The cabinet has a double-door design with a top glass panel. Below the glass is a large rectangular drawer. Underneath the drawer are three horizontal shelves. The cabinet is mounted on a base with a toe space. The drawing uses solid lines for the main structure and dashed lines to indicate hidden internal components like hinges and shelves.

FRONT  
VIEW

A technical line drawing showing the side view of the stainless steel cabinet. It illustrates the depth of the cabinet and the internal structure. The top glass panel is shown with a gasket. Below it is the drawer, which is supported by ball bearing slides. Three shelves are shown, with dashed lines indicating their adjustable positions. The cabinet is mounted on a base with a toe space. The drawing uses solid lines for the exterior and dashed lines for the interior components.

SIDE  
VIEW

# 7 Series Installation

- (1) Metal or wood stud with wallboard.
- (2) Metal backing, 16 gauge by others.
- (3) No. 10 sheet metal or wood screw.
- (4) Counter top, any type, not included.

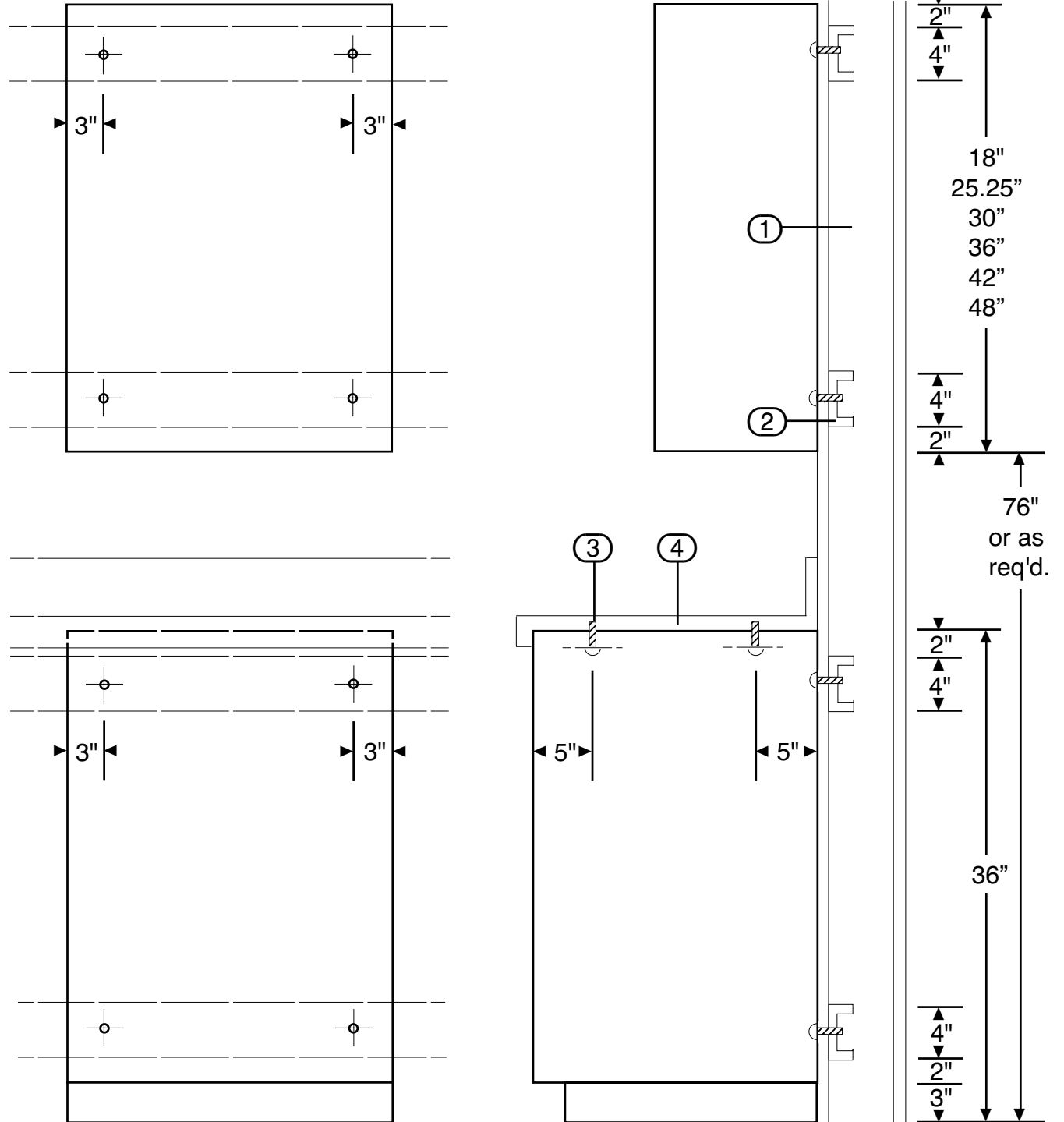

# 7 Series Base Cabinets Standing Height

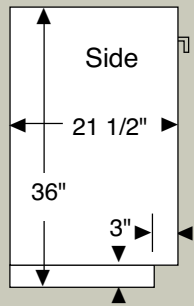

Model number last two digits are width.  
 \* Add "RH" or "LH" for right or left hinge.  
 † Add "RD" or "LD" for right or left side door.

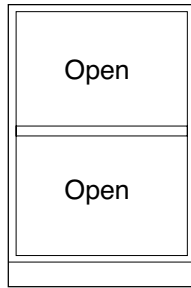

Open Front  
7300-18 7300-36  
7300-24 7300-42  
7300-30 7300-48

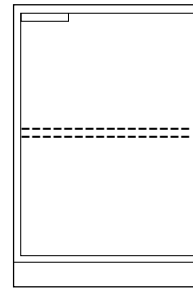

1 Door  
7301-12\*  
7301-15\*  
7301-18\*  
7301-24\*

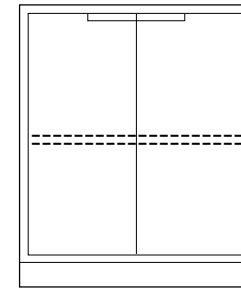

2 Door  
7302-30  
7302-36  
7302-42  
7302-48

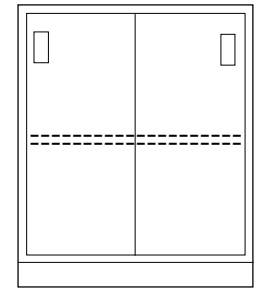

2 Sliding Door  
7303-30  
7303-42  
7303-36  
7303-48

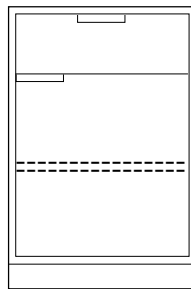

1 Door / 1 Drawer  
7304-18\*  
7304-24\*

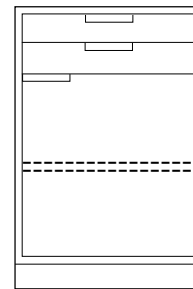

1 Door / 2 Drawer  
7305-18\*  
7305-24\*

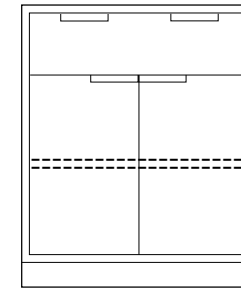

2 Door / 1 Drawer  
7306-30  
7306-36  
7306-42  
7306-48

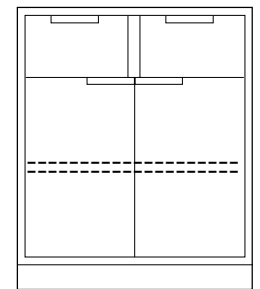

2 Door / 2 Drawer  
7307-30  
7307-36  
7307-42  
7307-48

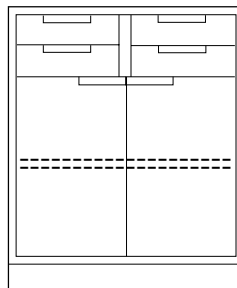

2 Door / 4 Drawer  
7308-30  
7308-36  
7308-42  
7308-48

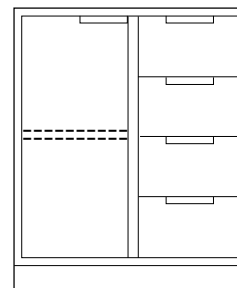

2 Door / 4 Drawer  
7309-30\*†  
7309-36\*†  
7309-42\*†  
7309-48\*†

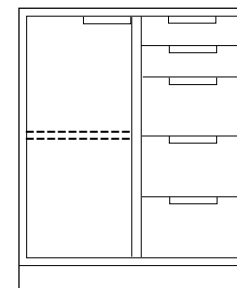

1 Door / 5 Drawer  
7310-30\*†  
7310-36\*†  
7310-42\*†  
7310-48\*†

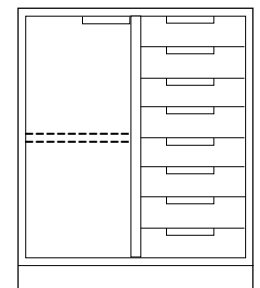

1 Door / 8 Drawer  
7311-30\*†  
7311-36\*†  
7311-42\*†  
7311-48\*†

# 7 Series Base Cabinets Standing Height

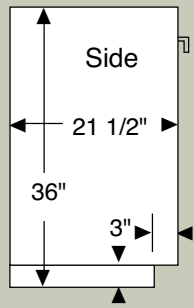

Model number last two digits are width.  
 \* Add "RH" or "LH" for right or left hinge.  
 † Add "RD" or "LD" for right or left side door.

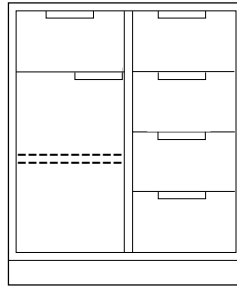

1 Door / 5 Drawer  
 7312-30\*†  
 7312-36\*†  
 7312-42\*†  
 7312-48\*†

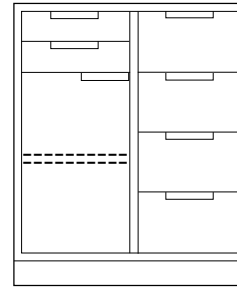

1 Door / 6 Drawer  
 7313-30\*†  
 7313-36\*†  
 7313-42\*†  
 7313-48\*†

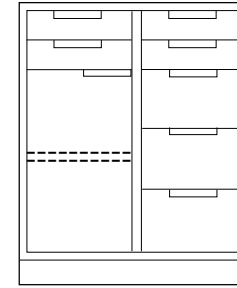

1 Door / 7 Drawer  
 7314-30\*†  
 7314-36\*†  
 7314-42\*†  
 7314-48\*†

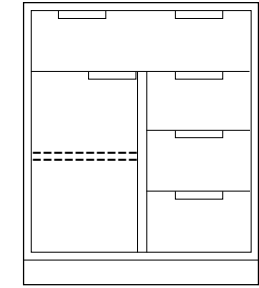

1 Door / 4 Drawer  
 7315-30\*†  
 7315-36\*†  
 7315-42\*†  
 7315-48\*†

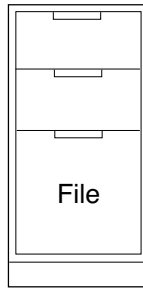

3 Drawer  
 7316-18

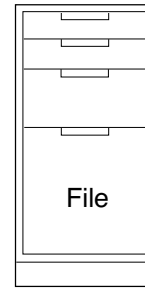

4 Drawer  
 7317-18

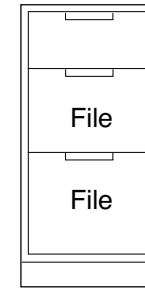

3 Drawer  
 7318-18

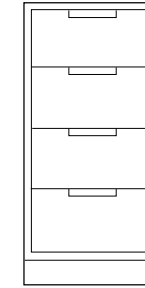

4 Drawer  
 7319-18  
 7319-24

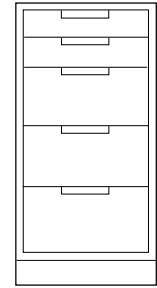

5 Drawer  
 7320-18  
 7320-24

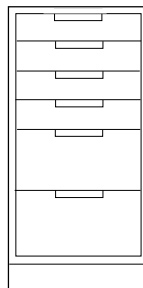

6 Drawer  
 7321-18  
 7321-24

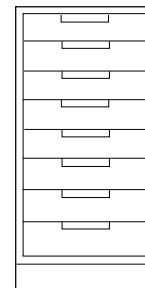

8 Drawer  
 7322-18  
 7322-24

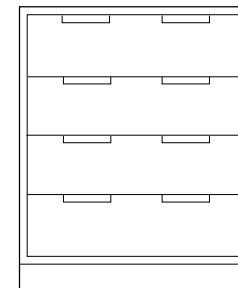

4 Drawer  
 7323-30  
 7323-36  
 7323-42  
 7323-48

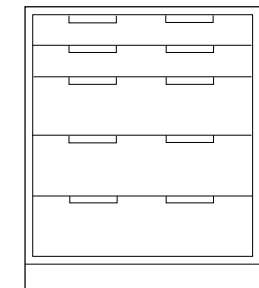

5 Drawer  
 7324-30  
 7324-36  
 7324-42  
 7324-48



# 7 Series Base Cabinets Standing Height

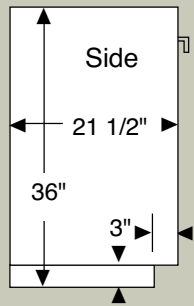

Model number last two digits are width.  
 \* Add "RH" or "LH" for right or left hinge.  
 † Add "RD" or "LD" for right or left side door.

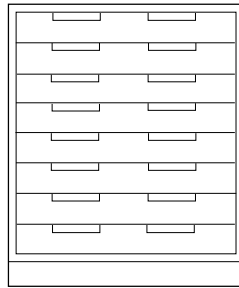

8 Drawer  
7325-30  
7325-36  
7325-42  
7325-48

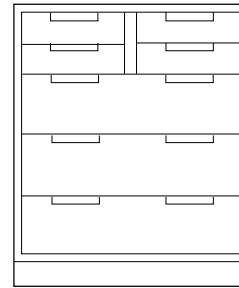

7 Drawer  
7326-30  
7326-36  
7326-42  
7326-48

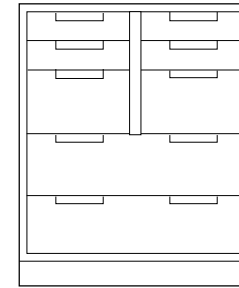

8 Drawer  
7327-30  
7327-36  
7327-42  
7327-48

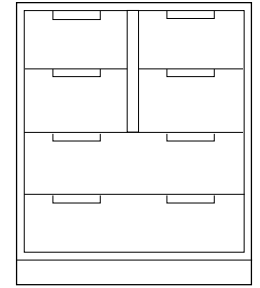

6 Drawer  
7328-30  
7328-36  
7328-42  
7328-48

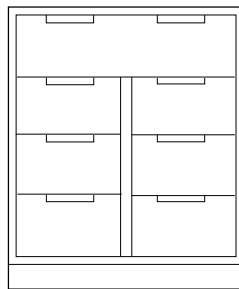

7 Drawer  
7329-30  
7329-36  
7329-42  
7329-48

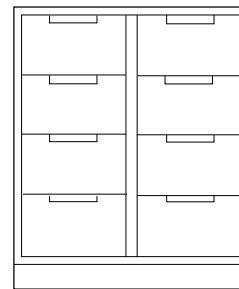

8 Drawer  
7330-30  
7330-36  
7330-42  
7330-48

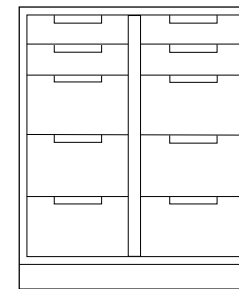

10 Drawer  
7331-30  
7331-36  
7331-42  
7331-48

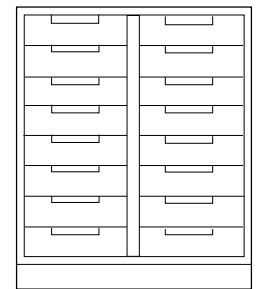

16 Drawer  
7332-30  
7332-36  
7332-42  
7332-48

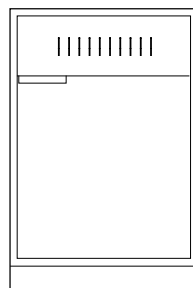

1 Door Sink Cabinet  
7333-18\*  
7333-24\*

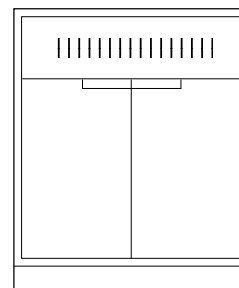

2 Door Sink Cabinet  
7334-30 7334-48  
7334-36 7334-52  
7334-42 7334-58

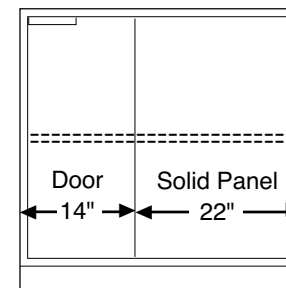

Corner Cabinet  
7335-36

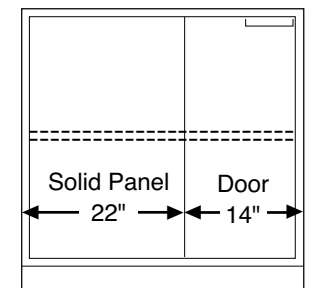

Corner Cabinet  
7336-36

# 7 Series Base Cabinets Full Height

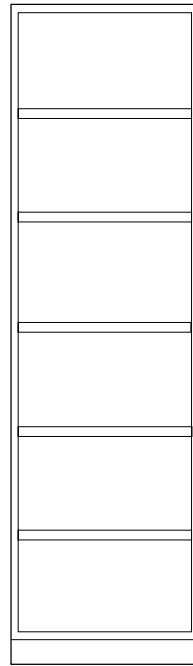
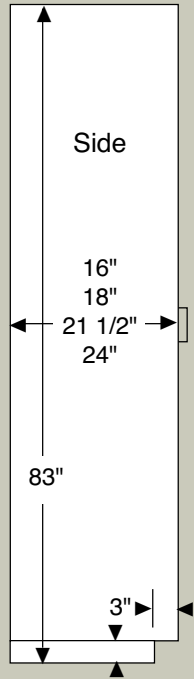

Open Front

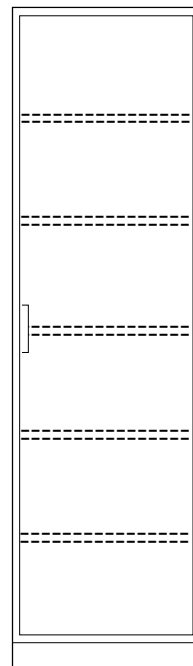

1 Door

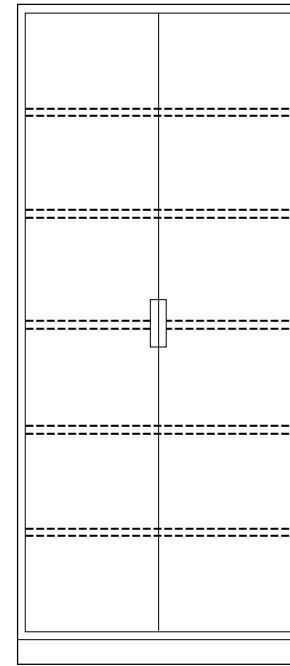

2 Door

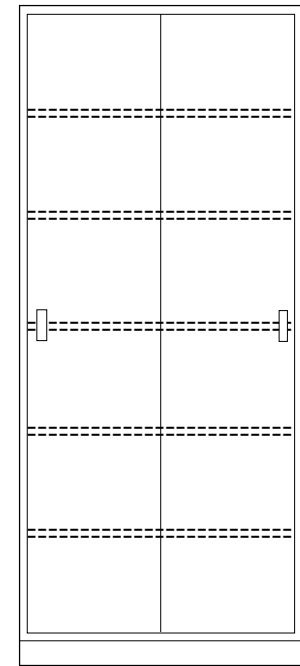

2 Sliding Doors

16" Deep	7337-18 7337-24	7341-18* 7341-24*	7345-30 7345-36 7345-42 7345-48	7349-30 7349-36 7349-42 7349-48
18" Deep	7338-18 7338-24	7342-18* 7342-24*	7346-30 7346-36 7346-42 7346-48	7350-30 7350-36 7350-42 7350-48
21.5" Deep	7339-18 7339-24	7343-18* 7343-24*	7347-30 7347-36 7347-42 7347-48	7351-30 7351-36 7351-42 7351-48
24" Deep	7340-18 7340-24	7344-18* 7344-24*	7348-30 7348-36 7348-42 7348-48	7352-30 7352-36 7352-42 7352-48

Model number last two digits are width.  
 \* Add "RH" or "LH" for right or left hinge.  
 † Add "RD" or "LD" for right or left side door.

# 7 Series Base Cabinets Full Height

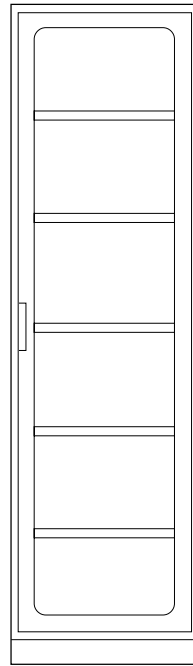
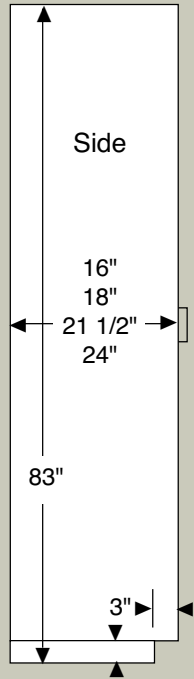

	1 Glass Door
16" Deep	7353-18* 7353-24*
18" Deep	7354-18* 7354-24*
21.5" Deep	7355-18* 7355-24*
24" Deep	7356-18* 7356-24*

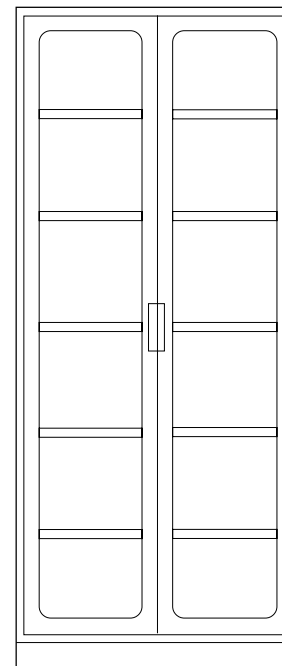

	2 Glass Door
16" Deep	7357-30 7357-36 7357-42 7357-48
18" Deep	7358-30 7358-36 7358-42 7358-48
21.5" Deep	7359-30 7359-36 7359-42 7359-48
24" Deep	7360-30 7360-36 7360-42 7360-48

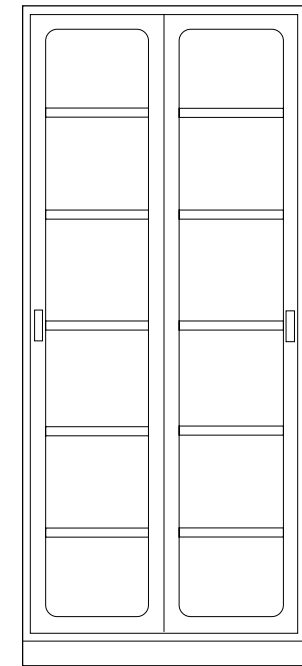

	2 Sliding Glass
16" Deep	7361-30 7361-36 7361-42 7361-48
18" Deep	7362-30 7362-36 7362-42 7362-48
21.5" Deep	7363-30 7363-36 7363-42 7363-48
24" Deep	7364-30 7364-36 7364-42 7364-48

Model number last two digits are width.  
 \* Add "RH" or "LH" for right or left hinge.  
 † Add "RD" or "LD" for right or left side door.

# 7 Series Base Cabinets Full Height

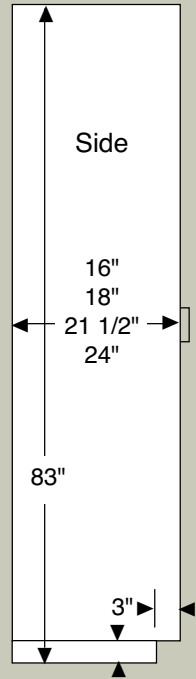

Model number last two digits are width.  
 ★ Add "RH" or "LH" for right or left hinge.  
 † Add "RD" or "LD" for right or left side door.

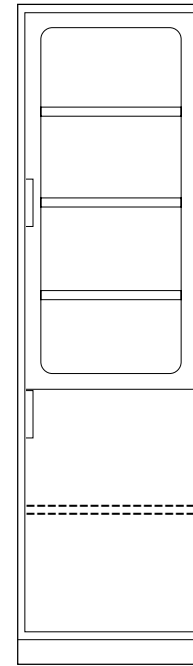

1 Glass, 1 Metal Door

16"	7365-18*
Deep	7365-24*
18"	7366-18*
Deep	7366-24*
21.5"	7367-18*
Deep	7367-24*
24"	7368-18*
Deep	7368-24*

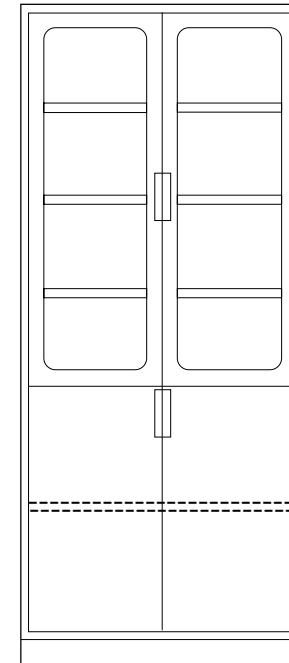

2 Glass, 2 Metal Door

16"	7369-30	7369-36
Deep	7369-42	7369-48
18"	7370-30	7370-36
Deep	7370-42	7370-48
21.5"	7371-30	7371-36
Deep	7371-42	7371-48
24"	7372-30	7372-36
Deep	7372-42	7372-48

# 7 Series Wall Cabinets 12" Deep

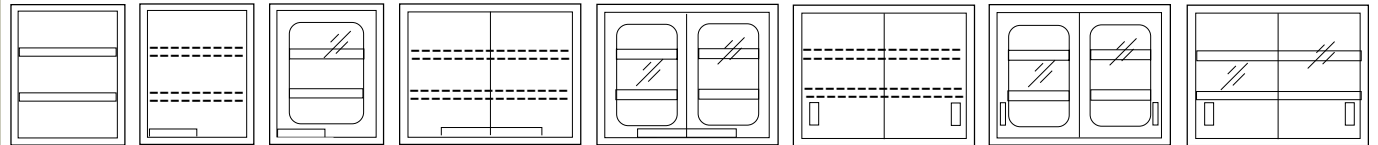
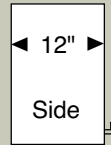

18" High,  
No Shelf

Open Front	1 Solid Door	1 Glass Door	2 Solid Doors	2 Glass Doors	2 Sliding Solid Doors	2 Sliding Glass Doors W/ Frame	2 Sliding Glass Doors No Frame
7373-18	7374-18*	7375-18*	7376-30	7377-30	7378-30	7379-30	7380-30
7373-24	7374-24*	7375-24*	7376-36	7377-36	7378-36	7379-36	7380-36
7373-30			7376-42	7377-42	7378-42	7379-42	7380-42
7373-36			7376-48	7377-48	7378-48	7379-48	7380-48
7373-42							
7373-48							

25.25" High,  
1 Shelf

7381-18	7382-18*	7383-18*	7384-30	7385-30	7386-30	7387-30	7388-30
7381-24	7382-24*	7383-24*	7384-36	7385-36	7386-36	7387-36	7388-36
7381-30			7384-42	7385-42	7386-42	7387-42	7388-42
7381-36			7384-48	7385-48	7386-48	7387-48	7388-48
7381-42							
7381-48							

Model number last two digits are width.  
★ Add "RH" or "LH" for right or left hinge.

30" High,  
2 Shelves

7389-18	7390-18*	7391-18*	7392-30	7393-30	7394-30	7395-30	7396-30
7389-24	7390-24*	7391-24*	7392-36	7393-36	7394-36	7395-36	7396-36
7389-30			7392-42	7393-42	7394-42	7395-42	7396-42
7389-36			7392-48	7393-48	7394-48	7395-48	7396-48
7389-42							
7389-48							

36" High,  
2 Shelves

7397-18	7398-18*	7399-18*	7400-30	7401-30	7402-30	7403-30	7404-30
7397-24	7398-24*	7399-24*	7400-36	7401-36	7402-36	7403-36	7404-36
7397-30			7400-42	7401-42	7402-42	7403-42	7404-42
7397-36			7400-48	7401-48	7402-48	7403-48	7404-48
7397-42							
7397-48							

42" High,  
2 Shelves

7405-18	7406-18*	7407-18*	7408-30	7409-30	7410-30	7411-30	7412-30
7405-24	7406-24*	7407-24*	7408-36	7409-36	7410-36	7411-36	7412-36
7405-30			7408-42	7409-42	7410-42	7411-42	7412-42
7405-36			7408-48	7409-48	7410-48	7411-48	7412-48
7405-42							
7405-48							

48" High,  
3 Shelves

7413-18	7414-18*	7415-18*	7416-30	7417-30	7418-30	7419-30	7420-30
7413-24	7414-24*	7415-24*	7416-36	7417-36	7418-36	7419-36	7420-36
7413-30			7416-42	7417-42	7418-42	7419-42	7420-42
7413-36			7416-48	7417-48	7418-48	7419-48	7420-48
7413-42							
7413-48							

# 7 Series Wall Cabinets 16" Deep

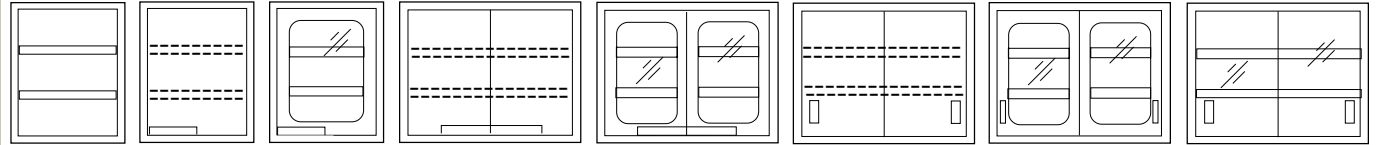
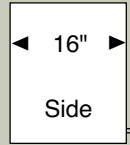

18" High,  
No Shelf

Open Front	1 Solid Door	1 Glass Door	2 Solid Doors	2 Glass Doors	2 Sliding Solid Doors	2 Sliding Glass Doors W/ Frame	2 Sliding Glass Doors No Frame
7421-18	7422-18*	7423-18*	7424-30	7425-30	7426-30	7427-30	7428-30
7421-24	7422-24*	7423-24*	7424-36	7425-36	7426-36	7427-36	7428-36
7421-30			7424-42	7425-42	7426-42	7427-42	7428-42
7421-36			7424-48	7425-48	7426-48	7427-48	7428-48
7421-42							
7421-48							

25.25" High,  
1 Shelf

7429-18	7430-18*	7431-18*	7432-30	7433-30	7434-30	7435-30	7436-30
7429-24	7430-24*	7431-24*	7432-36	7433-36	7434-36	7435-36	7436-36
7429-30			7432-42	7433-42	7434-42	7435-42	7436-42
7429-36			7432-48	7433-48	7434-48	7435-48	7436-48
7429-42							
7429-48							

Model number last two digits are width.  
★ Add "RH" or "LH" for right or left hinge.

30" High,  
2 Shelves

7437-18	7438-18*	7439-18*	7440-30	7441-30	7442-30	7443-30	7444-30
7437-24	7438-24*	7439-24*	7440-36	7441-36	7442-36	7443-36	7444-36
7437-30			7440-42	7441-42	7442-42	7443-42	7444-42
7437-36			7440-48	7441-48	7442-48	7443-48	7444-48
7437-42							
7437-48							

36" High,  
2 Shelves

7445-18	7446-18*	7447-18*	7448-30	7449-30	7450-30	7451-30	7452-30
7445-24	7446-24*	7447-24*	7448-36	7449-36	7450-36	7451-36	7452-36
7445-30			7448-42	7449-42	7450-42	7451-42	7452-42
7445-36			7448-48	7449-48	7450-48	7451-48	7452-48
7445-42							
7445-48							

42" High,  
2 Shelves

7453-18	7454-18*	7455-18*	7456-30	7457-30	7458-30	7459-30	7460-30
7453-24	7454-24*	7455-24*	7456-36	7457-36	7458-36	7459-36	7460-36
7453-30			7456-42	7457-42	7458-42	7459-42	7460-42
7453-36			7456-48	7457-48	7458-48	7459-48	7460-48
7453-42							
7453-48							

48" High,  
3 Shelves

7461-18	7462-18*	7463-18*	7464-30	7465-30	7466-30	7467-30	7468-30
7461-24	7462-24*	7463-24*	7464-36	7465-36	7466-36	7467-36	7468-36
7461-30			7464-42	7465-42	7466-42	7467-42	7468-42
7461-36			7464-48	7465-48	7466-48	7467-48	7468-48
7461-42							
7461-48							

# 7 Series Corner Wall Cabinets

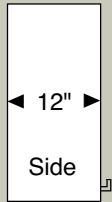

Model number last  
two digits are width.

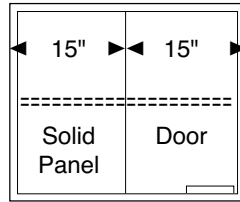
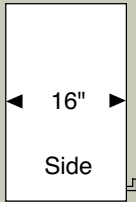

Corner Cabinet  
Solid Door, 30" Wide  
18" High 7469-30  
25.25" High 7470-30  
30" High 7471-30  
36" High 7472-30  
42" High 7473-30  
48" High 7474-30

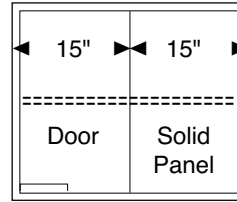

Corner Cabinet  
Solid Door, 30" Wide  
18" High 7475-30  
25.25" High 7476-30  
30" High 7477-30  
36" High 7478-30  
42" High 7479-30  
48" High 7480-30

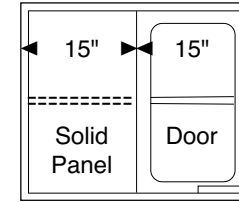

Corner Cabinet  
Glass Door, 30" Wide  
18" High 7481-30  
25.25" High 7482-30  
30" High 7483-30  
36" High 7484-30  
42" High 7485-30  
48" High 7486-30

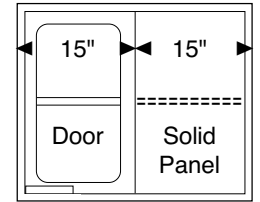

Corner Cabinet  
Glass Door, 30" Wide  
18" High 7487-30  
25.25" High 7488-30  
30" High 7489-30  
36" High 7490-30  
42" High 7491-30  
48" High 7492-30

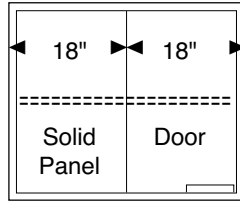

Corner Cabinet  
Solid Door, 36" Wide  
18" High 7493-36  
25.25" High 7494-36  
30" High 7495-36  
36" High 7496-36  
42" High 7497-36  
48" High 7498-36

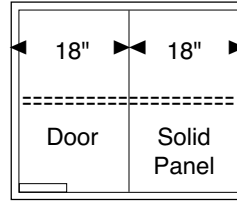

Corner Cabinet  
Solid Door, 36" Wide  
18" High 7499-36  
25.25" High 7500-36  
30" High 7501-36  
36" High 7502-36  
42" High 7503-36  
48" High 7504-36

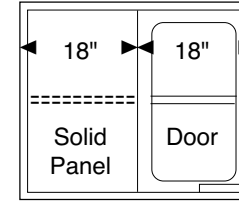

Corner Cabinet  
Glass Door, 36" Wide  
18" High 7505-36  
25.25" High 7506-36  
30" High 7507-36  
36" High 7508-36  
42" High 7509-36  
48" High 7510-36

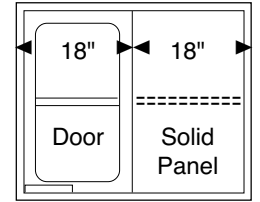

Corner Cabinet  
Glass Door, 36" Wide  
18" High 7511-36  
25.25" High 7512-36  
30" High 7513-36  
36" High 7514-36  
42" High 7515-36  
48" High 7516-36

# 7 Series Finishing Accessories

FILLER, VERTICAL TOP  
FVT (width) (height)

SLOPED TOP  
Standard height 9".  
ST (cab width) (cab depth)

FILLER, SLOPED TOP  
FST (width) (cab depth)

FILLER, CABINET SIDES  
FCS (width) (cab height) (cab depth)

COUNTER TOP  
Standard depth 22 1/2".  
CTOP (width) (depth)

APRON  
Standard height 3.75".  
APN (width) (height)

APRON DRAWER  
Std widths 18, 24, 30, 36. Std height 3.75".  
APD (width) (height)

BENCH END SUPPORT  
BES (height) (depth)

FILLER, CABINET BACK  
FCB (height) (depth)

